

Product Brochure

S-Line Single Pole Connectors





Table of Contents

| | |
|-----------|--------------------------------|
| 4 | About R&S Rauscher & Stoecklin |
| 5 | Introduction S-Line Connectors |
| 6 | General Information |
| 7 | Bayonet Locking System |
| 8 | Portfolio Overview |
| 9 | Colour Coding |
| 10 | Types of Connectors |
| 11 | Terminology |
| 12 | Areas of Application |
| 13 | Structure of a Connector |
| 14 | Technical Data |
| 16 | Order Information |
| 24 | Accessoires |
| 27 | Locations |

More than 100 years of know-how and competence.

Our company R&S Rauscher & Stoecklin, founded in 1919, is a well-established manufacturer of transformers, switchgear, industrial electrical connectors and other electrical equipment.

Based in Sissach, Switzerland, we have more than 100 years of experience in the production of high-end electrical products. In 2012, R&S Rauscher & Stoecklin became part of R&S, a leading provider of electrical infrastructure products around the globe.

The R&S portfolio includes

- Transformers
(Power, Distribution, Cast resin, Instrument)
- Switches
(High voltage, Medium voltage, Overhead line, Railway)
- Industrial electrical connectors
- Distribution boards
- Electric switchboards

Because of our flexibility and urge towards innovation, we are a reliable partner, capable of solving all challenges presented to us by our customers.

Our company is certified to all established standards and we have a passion for custom-made, project-specific products.

Reliable single pole connectors for maximum safety.

The S-Line connectors with a rated current of 500 A and 800 A are used in applications such as the event industry, marine, construction, power transmission and distribution.

The connectors are compatible with other Powerlock-connectors and are fully certified by UL, VDE, RoHS and CE standards.



General information of our S-Line connectors.

- Maximum current of 800A
- Colour coded according to the International Electrical Colour Coding Standard
- Locking mechanism to prevent connection errors and accidental disconnection under load
- Hardly inflammable (UL94-V0)
- Finger-proof contacts for maximum safety
- IP67 ingress protection
- Multipoint, self-wiping contact area
- High impact bodies
- High temperature resistant materials
- Integral cable strain relief
- Metric EN compliant cable glands
- Increased cable clamping range
- Easy assembly with standard tools
- Daisy chain hook-up system
- Panel mount connector & mounting plates
- Rubber hand grip for ease of coupling and added impact protection
- Rubber protective caps to protect connectors from moisture, dirt and abrasion when uncoupled (optional)

Bayonet locking system for highest reliability.

A bayonet locking system is a safe fastening mechanism consisting of a male connector with one or multiple pins, as well as a female receptor with matching slots to keep the two parts locked together. The slots are shaped like a capital letter L with a bend in order that the connector is no longer free to rotate unless pushed down against the spring.

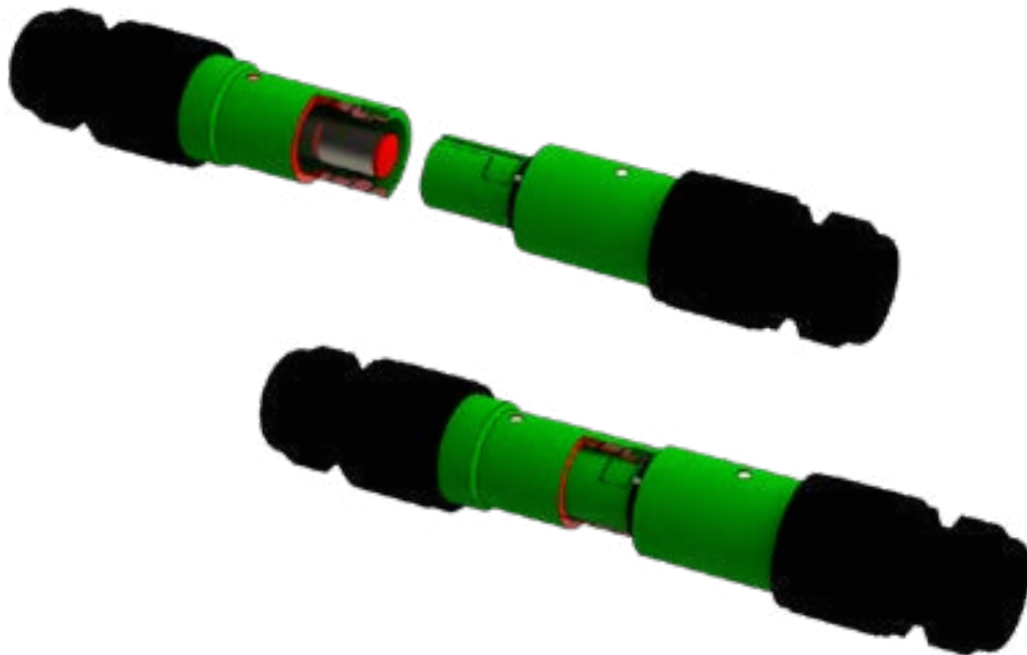

Portfolio Overview



S-Line 500A

The 500A S-Line single pole connectors are perfectly suitable for the increased demand for temporary high power systems in entertainment & industrial applications.



S-Line 800A

The 800A S-Line single pole connectors are designed for special applications in the marine, military and event industry, where high currents are demanded.



Mating Box

The Mating Box is the ideal equipment to easy install all phases L1, L2, L3 as well as with the N-Phase and Earthing in one housing

Colour Coding



L1-Connector



L2-Connector



L3-Connector



N-Connector



E-Connector

International Electrical Colour Coding Standards

| Region | Earth (E) | Neutral (N) | Line 1 (1) | Line 2 (2) | Line 3 (3) |
|--------------------------|-----------|-------------|------------|------------|------------|
| Europe & UK (Harmonised) | Green | Blue | Brown | Black | Grey |
| UK (Traditional) | Green | Black | Red | Yellow | Blue |
| Australia | Green | Black | Red | White | Blue |
| USA | Green | Black | Black | Red | Blue |

Types of Connectors

Male Connectors



Line Drain

Female Connectors



Line Source



Panel Drain



Panel Source

*Product overview using the example of the L2-connector

Terminology

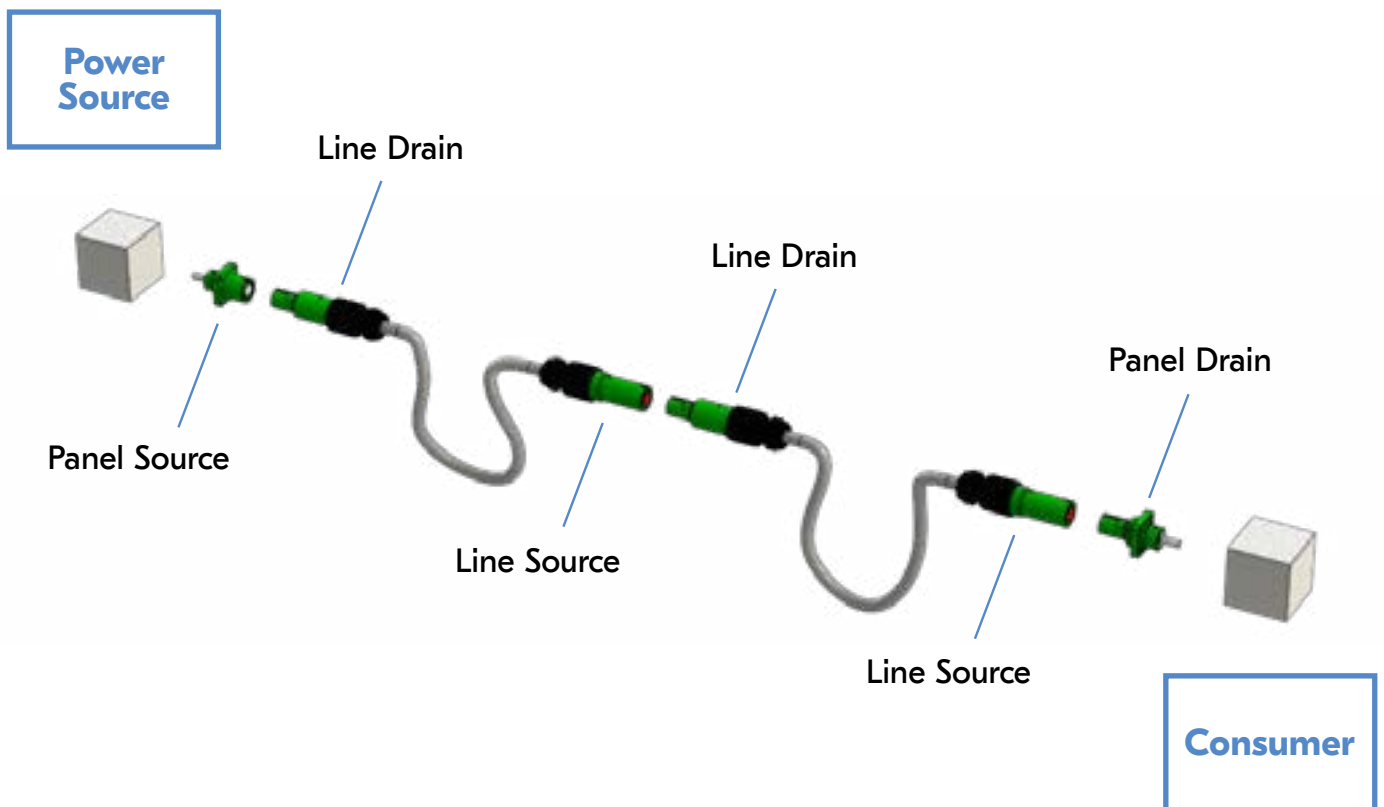

Areas of application



Events

The single pole connectors are ideal for the event and entertainment industry due to their small dimensions.



Marine

The single pole connectors are often used for fast power supply in the marine segment, for example in shore to ship power connection.



Construction

Numerous protection mechanisms make our connectors the most safe products of the construction site.



Power transmission and distribution

Easy handling and low weight of connectors and cables make the single pole connectors most suitable for generators and other power transmission and distribution equipment.

Structure of a connector

1. Housing

Plastic housing designed for rough environments. Easy to handle.

2. Fixing pin

For easy assembly of the single pole connectors.

3. Contact pin

Advanced contact design for reliable and safe power transmission.

4. Cable gland

Built-in cable gland for fast cable connection.

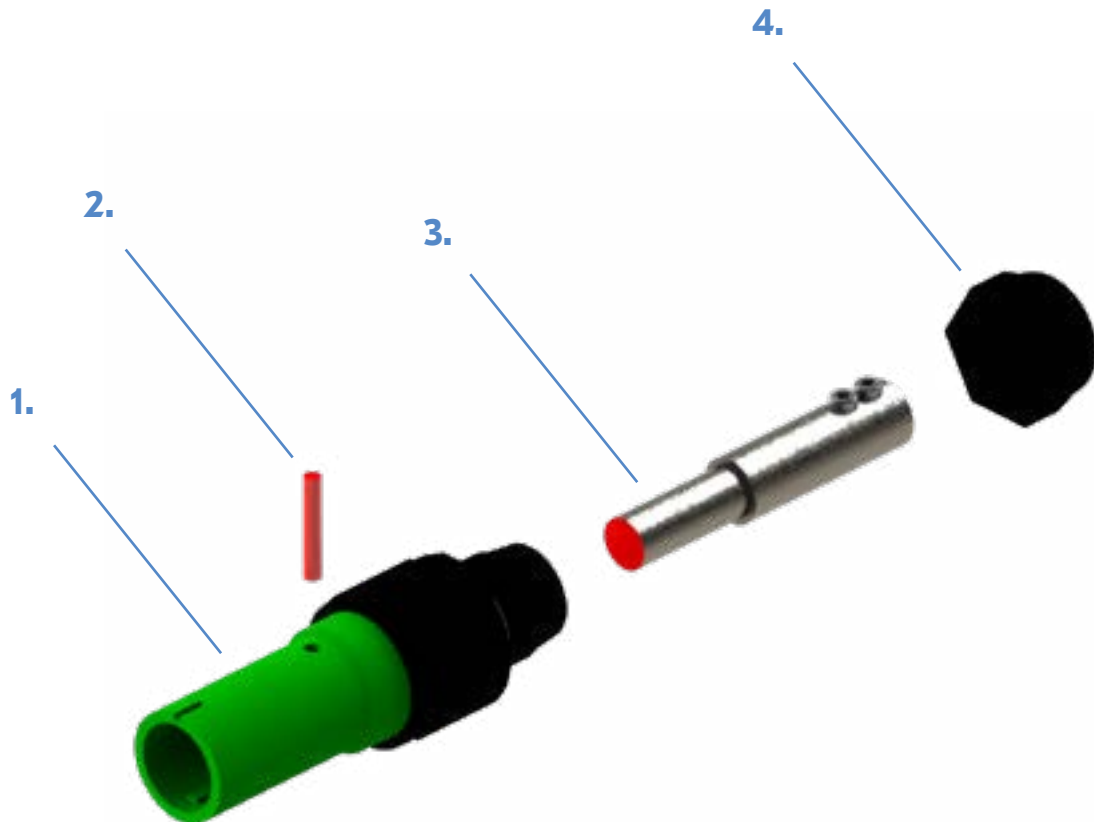

S-Line Connectors

Technical Data



| Technical Data | Unit | 500A | 800A |
|-------------------------------------|-----------------|------|--------------------------------|
| No of Contacts | | | 1 |
| Max Continuous Current Rating | A | 500 | 800 |
| Surge Current | kA | | 75 |
| Short Circuit Rating | kA | | up to 35.5 |
| Cables Cross Sectional Area C.S.A. | mm ² | | 25 to 300 |
| Contact Termination | | | Screw or Crimp |
| Mating Method | | | Bayonet Lock |
| Operating Voltage | V | | 1000 (AC) |
| Max Rated Voltage to Earth | kV | | 2 (AC) / 3 (DC) |
| Min Flashover | kV | | 9.5 (DC) / Peak (AC) |
| Insulation Resistance | V | | >5M ohms @ 500 (DC) |
| Ingress Protection | | | IP67 |
| Protection against Electrical Shock | | | IP2X |
| Flammability | | | UL94-V0 |
| Mating Cycles | | | >500 |
| Shell Material | | | High Temperature Thermoplastic |
| Contact Plating | | | Silver |



S-Line Connectors

Line Source

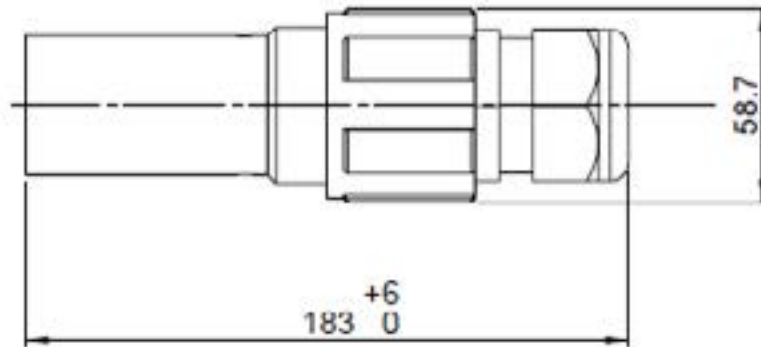

| Current (A) | Type designation | Cable gland range in mm | Termination | Article No. |
|-------------|------------------|--------------------------|--------------------------|-------------|
| 500 | L1 (Brown) | 19-28 | Screw 120mm ² | 27010 |
| | | | Crimp 95mm ² | 27011 |
| | | | Crimp 120mm ² | 27012 |
| | | | Crimp 150mm ² | 27013 |
| | L2 (Black) | 19-28 | Screw 120mm ² | 27014 |
| | | | Crimp 95mm ² | 27015 |
| | | | Crimp 120mm ² | 27016 |
| | | | Crimp 150mm ² | 27017 |
| | L3 (Grey) | 19-28 | Screw 120mm ² | 27018 |
| | | | Crimp 95mm ² | 27019 |
| | | | Crimp 120mm ² | 27020 |
| | | | Crimp 150mm ² | 27021 |
| N (Blue) | 19-28 | Screw 120mm ² | 27022 | |
| | | Crimp 95mm ² | 27023 | |
| | | Crimp 120mm ² | 27024 | |
| | | Crimp 150mm ² | 27025 | |
| PE (Green) | 19-28 | Screw 120mm ² | 27026 | |
| | | Crimp 95mm ² | 27027 | |
| | | Crimp 120mm ² | 27028 | |
| | | Crimp 150mm ² | 27029 | |

S-Line Connectors

Line Source



| Current (A) | Type designation | Cable gland range in mm | Termination | Article No. |
|--------------------------|------------------|--------------------------|--------------------------|-------------|
| 500 | L1 (Brown) | 22-32 | Screw 150mm ² | 27030 |
| | | | Crimp 150mm ² | 27031 |
| | | | Crimp 185mm ² | 27032 |
| | L2 (Black) | 22-32 | Screw 150mm ² | 27033 |
| | | | Crimp 150mm ² | 27034 |
| | | | Crimp 185mm ² | 27035 |
| | L3 (Grey) | 22-32 | Screw 150mm ² | 27036 |
| | | | Crimp 150mm ² | 27037 |
| | | | Crimp 185mm ² | 27038 |
| | N (Blue) | 22-32 | Screw 150mm ² | 27039 |
| Crimp 150mm ² | | | 27040 | |
| Crimp 185mm ² | | | 27041 | |
| PE (Green) | 22-32 | Screw 150mm ² | 27042 | |
| | | Crimp 150mm ² | 27043 | |
| | | Crimp 185mm ² | 27044 | |

S-Line Connectors

Line Source



| Current (A) | Type designation | Cable gland range in mm | Termination | Article No. |
|-------------|------------------|-------------------------|--------------------------|-------------|
| 800 | L1 (Brown) | 22-32 | Crimp 240mm ² | 27055 |
| | L2 (Black) | 22-32 | Crimp 240mm ² | 27056 |
| | L3 (Grey) | 22-32 | Crimp 240mm ² | 27057 |
| | N (Blue) | 22-32 | Crimp 240mm ² | 27058 |
| | PE (Green) | 22-32 | Crimp 240mm ² | 27059 |
| | L1 (Brown) | 30-38 | Crimp 240mm ² | 27060 |
| | L2 (Black) | 30-38 | Crimp 240mm ² | 27061 |
| | L3 (Grey) | 30-38 | Crimp 240mm ² | 27062 |
| | N (Blue) | 30-38 | Crimp 240mm ² | 27063 |
| | PE (Green) | 30-38 | Crimp 240mm ² | 27064 |
| | L1 (Brown) | 22-32 | Crimp 300mm ² | 27065 |
| | L2 (Black) | 22-32 | Crimp 300mm ² | 27066 |
| | L3 (Grey) | 22-32 | Crimp 300mm ² | 27067 |
| | N (Blue) | 22-32 | Crimp 300mm ² | 27068 |
| | PE (Green) | 22-32 | Crimp 300mm ² | 27069 |
| | L1 (Brown) | 30-38 | Crimp 300mm ² | 27070 |
| | L2 (Black) | 30-38 | Crimp 300mm ² | 27071 |
| | L3 (Grey) | 30-38 | Crimp 300mm ² | 27072 |
| | N (Blue) | 30-38 | Crimp 300mm ² | 27073 |
| | PE (Green) | 30-38 | Crimp 300mm ² | 27074 |

S-Line Connectors

Panel Source

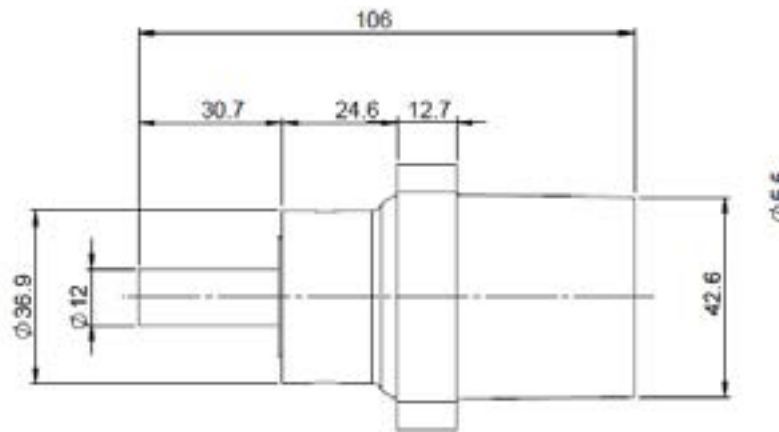

| Current (A) | Type designation | Termination | Article No. |
|-------------|------------------|-------------|-------------|
| 500 | L1 (Brown) | T5 Thread | 27075 |
| | L2 (Black) | T5 Thread | 27076 |
| | L3 (Grey) | ST5 Thread | 27077 |
| | N (Blue) | T5 Thread | 27078 |
| | PE (Green) | T5 Thread | 27079 |
| 800 | L1 (Brown) | T8 Thread | 27080 |
| | L2 (Black) | T8 Thread | 27081 |
| | L3 (Grey) | T8 Thread | 27082 |
| | N (Blue) | T8 Thread | 27083 |
| | PE (Green) | T8 Thread | 27084 |

S-Line Connectors

Line Drain

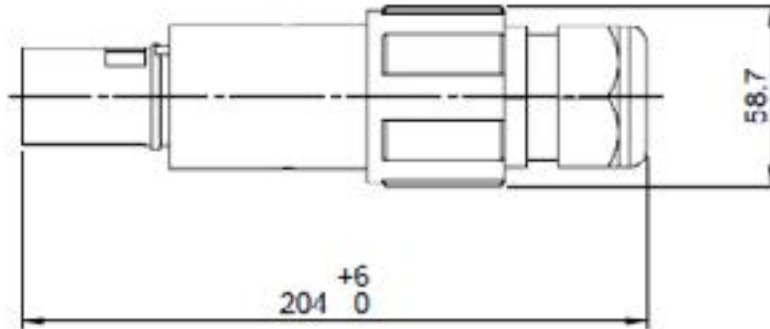

| Current (A) | Type designation | Cable gland range in mm | Termination | Article No. |
|-------------|------------------|--------------------------|--------------------------|-------------|
| 500 | L1 (Brown) | 19-28 | Screw 120mm ² | 27085 |
| | | | Crimp 95mm ² | 27086 |
| | | | Crimp 120mm ² | 27087 |
| | | | Crimp 150mm ² | 27088 |
| | L2 (Black) | 19-28 | Screw 120mm ² | 27089 |
| | | | Crimp 95mm ² | 27090 |
| | | | Crimp 120mm ² | 27091 |
| | | | Crimp 150mm ² | 27092 |
| | L3 (Grey) | 19-28 | Screw 120mm ² | 27093 |
| | | | Crimp 95mm ² | 27094 |
| | | | Crimp 120mm ² | 27095 |
| | | | Crimp 150mm ² | 27096 |
| N (Blue) | 19-28 | Screw 120mm ² | 27097 | |
| | | Crimp 95mm ² | 27098 | |
| | | Crimp 120mm ² | 27099 | |
| | | Crimp 150mm ² | 27100 | |
| PE (Green) | 19-28 | Screw 120mm ² | 27101 | |
| | | Crimp 95mm ² | 27102 | |
| | | Crimp 120mm ² | 27103 | |
| | | Crimp 150mm ² | 27104 | |

S-Line Connectors

Line Drain



| Current (A) | Type designation | Cable gland range in mm | Termination | Article No. |
|--------------------------|------------------|--------------------------|--------------------------|-------------|
| 500 | L1 (Brown) | 22-32 | Screw 150mm ² | 27105 |
| | | | Crimp 150mm ² | 27106 |
| | | | Crimp 185mm ² | 27107 |
| | L2 (Black) | 22-32 | Screw 150mm ² | 27108 |
| | | | Crimp 150mm ² | 27109 |
| | | | Crimp 185mm ² | 27110 |
| | L3 (Grey) | 22-32 | Screw 150mm ² | 27111 |
| | | | Crimp 150mm ² | 27112 |
| | | | Crimp 185mm ² | 27113 |
| | N (Blue) | 22-32 | Screw 150mm ² | 27114 |
| Crimp 150mm ² | | | 27115 | |
| Crimp 185mm ² | | | 27116 | |
| PE (Green) | 22-32 | Screw 150mm ² | 27117 | |
| | | Crimp 150mm ² | 27118 | |
| | | Crimp 185mm ² | 27119 | |

S-Line Connectors

Line Drain



| Current (A) | Type designation | Cable gland range in mm | Termination | Article No. |
|-------------|------------------|-------------------------|--------------------------|-------------|
| 800 | L1 (Brown) | 22-32 | Crimp 240mm ² | 27120 |
| | L2 (Black) | 22-32 | Crimp 240mm ² | 27121 |
| | L3 (Grey) | 22-32 | Crimp 240mm ² | 27122 |
| | N (Blue) | 22-32 | Crimp 240mm ² | 27123 |
| | PE (Green) | 22-32 | Crimp 240mm ² | 27124 |
| | L1 (Brown) | 30-38 | Crimp 240mm ² | 27125 |
| | L2 (Black) | 30-38 | Crimp 240mm ² | 27126 |
| | L3 (Grey) | 30-38 | Crimp 240mm ² | 27127 |
| | N (Blue) | 30-38 | Crimp 240mm ² | 27128 |
| | PE (Green) | 30-38 | Crimp 240mm ² | 27129 |
| | L1 (Brown) | 22-32 | Crimp 300mm ² | 27130 |
| | L2 (Black) | 22-32 | Crimp 300mm ² | 27131 |
| | L3 (Grey) | 22-32 | Crimp 300mm ² | 27132 |
| | N (Blue) | 22-32 | Crimp 300mm ² | 27133 |
| | PE (Green) | 22-32 | Crimp 300mm ² | 27134 |
| | L1 (Brown) | 30-38 | Crimp 300mm ² | 27135 |
| | L2 (Black) | 30-38 | Crimp 300mm ² | 27136 |
| | L3 (Grey) | 30-38 | Crimp 300mm ² | 27137 |
| | N (Blue) | 30-38 | Crimp 300mm ² | 27138 |
| | PE (Green) | 30-38 | Crimp 300mm ² | 27139 |

S-Line Connectors

Panel Drain

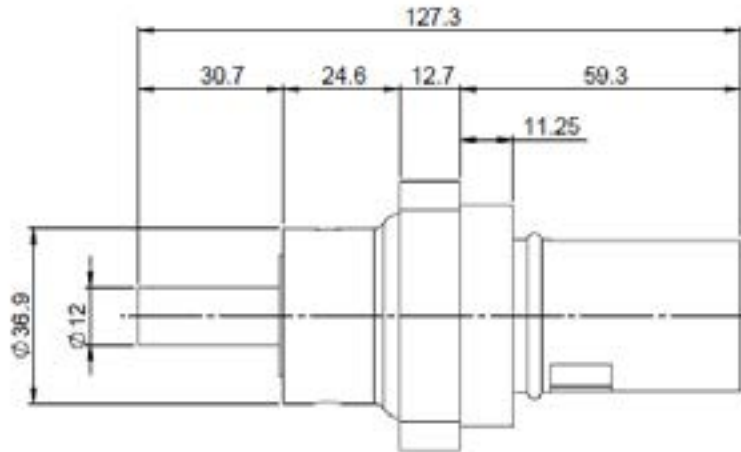

| Current (A) | Type designation | Termination | Article No. |
|-------------|------------------|-------------|-------------|
| 500 | L1 (Brown) | T5 Thread | 27140 |
| | L2 (Black) | T5 Thread | 27141 |
| | L3 (Grey) | ST5 Thread | 27142 |
| | N (Blue) | T5 Thread | 27143 |
| | PE (Green) | T5 Thread | 27144 |
| 800 | L1 (Brown) | T8 Thread | 27145 |
| | L2 (Black) | T8 Thread | 27146 |
| | L3 (Grey) | T8 Thread | 27147 |
| | N (Blue) | T8 Thread | 27148 |
| | PE (Green) | T8 Thread | 27149 |

Accessoires



45° Adapter

The 45° adapter is designed for a better plug in process to the panel drain or panel source

On Request.



Reduction Sleeve Kit

Reduction sleeve kits for screw termination for the use with smaller diameter cables from 25mm up to 95mm.

On Request.

Accessoires



Rotalock

The Rotalock are designed for greater cable extensions.

On Request.

Suitable for all designs:

- Line Drain
- Line Source
- Panel Drain
- Panel Source

Products customized to your own needs

If standard solutions do not meet all the requirements of an application, customer-specific solutions are made upon request.

In doing so, the customer is involved in each development step, thus enabling us to come up with a perfect solution. In this area, R&S Rauscher & Stoecklin has extensive know-how and numerous reference projects.





Switzerland

R&S International Holding AG
Reuslistrasse 32
4450 Sissach
+41 61 976 34 66
info@the-rsgroup.com

Switzerland

Rauscher & Stoecklin AG
Reuslistrasse 32
4450 Sissach
+41 61 976 34 66
info@raustoc.ch

Italy

Tesar S.r.l.
Loc. Chiaveretto 37/B
52010 Subbiano Arezzo
+39 0575 3171
info@tesar.eu

Czech Republic

SERW spol. s.r.o.
Tymákovská 42 Sedlec
332 02 Starý Plzenec
+420 377 965 057
serw@serw.cz

Poland

ZREW Transformatory S.A.
ul. Rokicińska 144
92-412 Łódź
+48 42 671 86 00
transformatory@zrew-tr.pl

Poland

Tesar Polska Sp. z o.o.
ul. Skarbowa 34
32-005 Niepołomice
+48 12 312 90 41
info@tesarpolska.pl

UAE

Tesar FZE
Dubai Airport Free Zone
Office 118, Building 5E, Block A
+971 4 2045305/06
tesarfze@tesar.eu

UAE

Tesar Gulf
P.O. Box #13898
Al Ain
+971 3 7847900
tesarfze@tesar.eu

Argentina

Tadeo Czerweny Tesar S.A.
Av. República 328 (S2252BQQ)
Gálvez, Santa Fe
+54 3404 48 7200
info@tesar.eu

